

MEETING FACILITIES - SECOND FLOOR

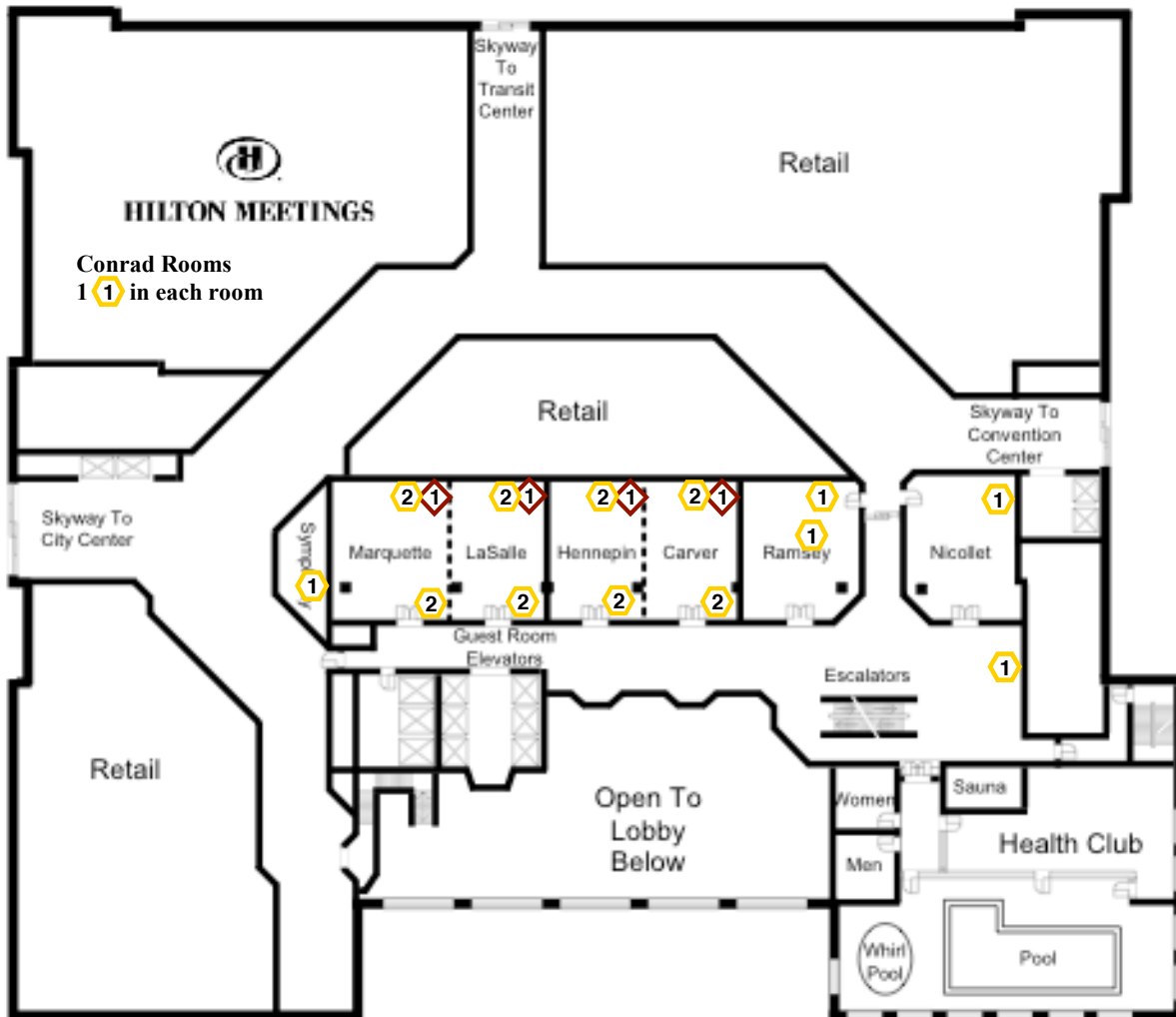

ROOM NUMBER	Square Feet	Ceiling Height	Theater	Classroom	Banquet	Reception
Marquette & LaSalle	2,440	11'	224	148	180	280
Marquette	1,520	11'	140	68	100	150
LaSalle	1,120	11'	124	68	80	130
Hennepin & Carver	2,120	11'	208	132	150	240
Hennepin	1,120	11'	124	68	90	130
Carver	1,080	11'	110	48	80	115
Nicollet	1,312	11'	130	68	90	140
Ramsey	1,312	11'	130	68	90	140

1001 Marquette Avenue • Minneapolis, Minnesota 55403

Telephone (612) 376-1000 FAX (612) 397-4871

Key:

- Fiber termination, Brown net distribution panel
- Brown Net - Distributed from 3rd floor Coat room
- White Net - Distributed from 4th floor Switch room
(Number shows jack count)

23rd Floor Lounge

(1)

Penthouse (by roof door)

(2)

MEETING FACILITIES - THIRD FLOOR



ROOM NUMBER	ROOM DIMENSIONS		ROOM CAPACITIES			
	Square Feet	Ceiling Height	Theater	Classroom	Banquet	Reception
Grand Ballroom	24,780	20'/14'5"	2,576	1,440	1,950	2,850
Salon A, B, C Each	2,769	20'/14'5"	290	172	220	320
Salon E, F, G Each	2,652	20'/14'5"	270	154	210	305
A, B, C Combined	8,378	20'/14'5"	930	524	660	960
Salon D	8,378	20'/14'5"	1,010	524	700	960
E, F, G Combined	8,024	20'/14'5"	880	486	640	920
Rochester	1,785	11'	132	48	150	205
Board Room 3	676	10'	Permanent Seating for 18 People			
Board Room 1 & 2	624	10'	60	32	50	70
Directors Row 1	676	10'	65	32	50	80
Directors Row 2, 3, 4	624	10'	60	32	50	70
Duluth	2,145	10'	150	96	150	250
Coat Room	1,040	10'	96	48	80	120

1001 Marquette Avenue • Minneapolis, Minnesota 55403

Telephone (612) 376-1000 FAX (612) 397-4871